

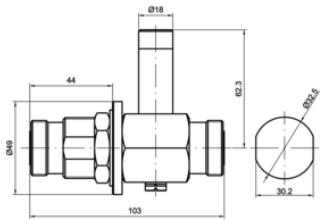

CITEL

PRC822S-716W/FF



Electrical Characteristics		
Frequency range	f	800-2200 MHz
Insertion loss		< 0.2 dB
Return loss		> 20 dB
Impedance		50 ohms
VSWR		<1.2:1
Max. load current @25°C	IL	10 A
Protection mode(s)		Common mode
Impulse current 2 x 10/350µs Test - D1 Category	limp	50 kA
Nominal discharge current C2 Category	In	50 kA
Max Power @f mini.		2959 W
PIM 3rd order (2x20W)		< -160 dBc
DC Pass		No
Mechanical Characteristics		
Connection to Network		Connector 7/16 Female/Female
Contacts		Bronze/Surface Au-Ag
Insulation material		PTFE
Standards		
RohS compliance		Yes
Part number		
621105		

