



CITEL

P8AX09-F/FF



>4GHz Bi-Directional Coaxial Surge Protector - High Energy GDT Technology - Low Insertion Loss - Field Replaceable GDT - Waterproof Design - DC Pass - UL497E Listed

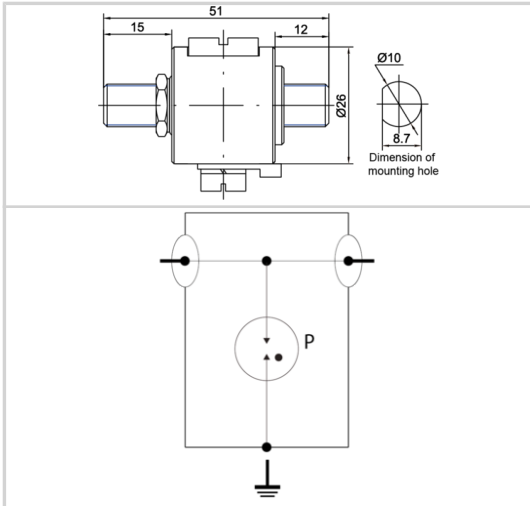

Características eléctricas			
Tensión DC máx. de operación	Uc		72 Vdc
Gama de frecuencia	f		DC-2 GHz
Perdida de inserción			< 0.5 dB
Return loss			> 18 dB
Impedancia			75 ohms
VSWR - ROE			< 1.3:1
Corriente máx. De línea @25°C	IL		10 A
Modo(s) de protección			Modo común
Corriente de choque Prueba 10/350µs x 2 - categoría D1	Iimp		1 kA
Corriente de descarga nominal Prueba 8/20µs x 10 - categoría C2	In		5 kA
Potencia máx.			15 W
DC Pass			Yes
Resistencia de aislamiento	IR		≥10 GOhms
RF Power	W		25.0000
Return Loss	db		>20
VSWR	:1		<1.3
Max Total Discharge Current	kA		10.0000
Max Discharge Current	kA		10.0000
RF SPD TYPE			UL497E LISTED
TENSION	(V)		48
AC/DC/DC PV/RF			RF
WIRES			1W+GROUND
LINE CURRENT MAX	(A)		10
AMBIENT MIN	(C)		-40
AMBIENT MAX	(C)		+85
IMAX	(kA)		20
FREQUENCY RANGE	(GHz)		0-4.0
INSERTION LOSS (@ FREQ)	(db)		<0.2
RETURN LOSS	(db)		>22
VSWR			<1.25:1
Instalación			
Operating Temperature	°C		-45.0000
Operating Temperature	°C		85.0000
Operating Temperature	°F		-50.0000
Operating Temperature	°F		85.0000
Operating Relative Humidity	%RH		Can be submerged
Operating Altitude	Ft		2000.0000
Operating Altitude	Ft		6500.0000
Housing/Enclosure material			Cu, Zn, Sn plated Brass
Mounting			Bracket or through hole
IP Environmental rating			IP65
NEMA Environmental rating			NEMA 4
Installation Location			Indoor / outdoor
Spare part			BB HF 90/20
Accesorio			BK
Product Dimension	mm		51.0000
Product Dimension	mm		26.0000
Product Dimension	mm		8.7000
Product Dimension	In		2.0100
Product Dimension	In		1.0200
Product Dimension	In		0.3400
Miscelánea			
Individual Pack			No

Storage Temperature	°C	-40.0000
Storage Temperature	°C	85.0000
Storage Temperature	°F	-40.0000
Storage Temperature	°F	85.0000
Características mecánicas		
Conexión a la red		Conector F Hembra/Hembra
Contact		Bronce/Superficie Au-Ag
aislamiento		PTFE
Peso		0.096 kg
TECNOLOGIA		GDT
FORMA DE CONEXION		SERIES CONNECTOR, BI-DIRECTIONAL
MONTAJE		BULKHEAD, OPTIONAL BRACKET
MATERIAL		Cu, Zn, Sn plated Brass, PTFE
NEMA RATING (IP RATING)		NEMA 6P (IP67)
DIMENSIONS		See diagram
WEIGHT		0.30 lbs
Normas		
Conformidad RoHs		Si
UL STANDARD		UL497E
UL CATEGORY		QVLA
UL FILE NUMBER		E349646
NORMAS		NOM-003-SCFI-2014, NOM-001-SCFI-1993
ENVIRONMENTAL STANDARDS		ROHS
Código		
60211		