

Accessories for E280 Plug-In Modules

BN , FPSU , MMP

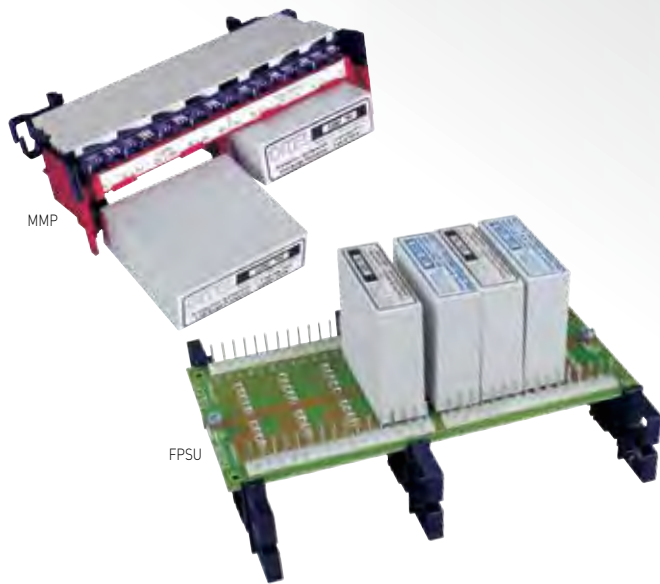

- **BN series : 8, 16 or 32 pair**
Metal enclosures for E280
- **FPSU series : 4, 8 or 16 pair**
For MDF or DIN rail mounting
- **FP series : 10 or 25 pair**
Wall mounting plate
- **MMP module : 4 pair**
Connector strip for 2 E280

Dimensions

(in mm)

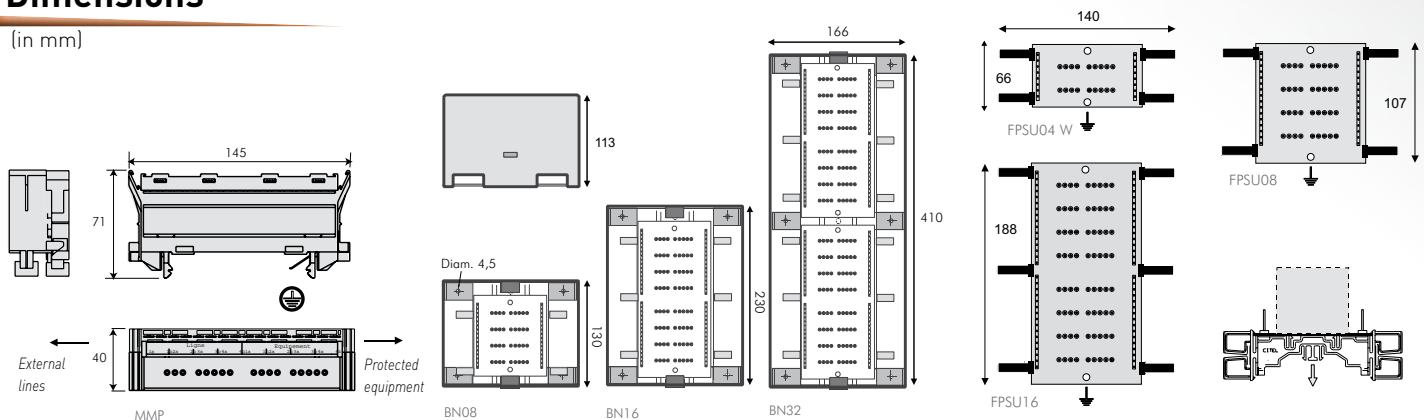

Characteristics

Form Factor	Metal Enclosures			Brackets and Boards					Strip
CITEL Part Number	BN08	BN16	BN32	FPSU04	FPSU08	FPSU16	FP10	FP25	MMP
Maximum Number of Pairs	8	16	32	4	8	16	10	25	4
Maximum Number of E280s	4	8	16	2	4	8	5	13	2
I/O Connection :									
Screw Terminals	BN08V	BN16V	BN32V	FPSU04V	FPSU08V	FPSU16V	-	-	-
Quick Connect 66 (USA)	-	-	-	-	-	-	FP10QC66	FP25QC66	MMP
ATT110 (USA)	-	-	-	-	-	-	FP10-110	-	-
Mounting System	Wall	Wall	Wall	MDF* DIN rail	MDF* DIN rail	MDF* DIN rail	Wall	Wall	MDF*
Ground Connection	2 nuts with M4 screws			2 nuts with M4 screws					Earth pin
Part Number									
Screw Terminals	71347	71356	71377	71442	71462	71472	-	-	-
Quick Connect	-	-	-	-	-	-	71435	71475	71480
ATT110	-	-	-	-	-	-	-	-	-

*] Compatible with MDF profile : PA015001 (Infra+), HPU (3M-Pouyet), 09649 (Alcatel) and CITEL profile